

# Resilient Seated Solid Wedge Gate Valve With Bevel Gear Operator - Series 6600

AWWA C509 & C515 ▪ NRS Type ▪ FL x MJ ▪ Sizes 30" - 48"

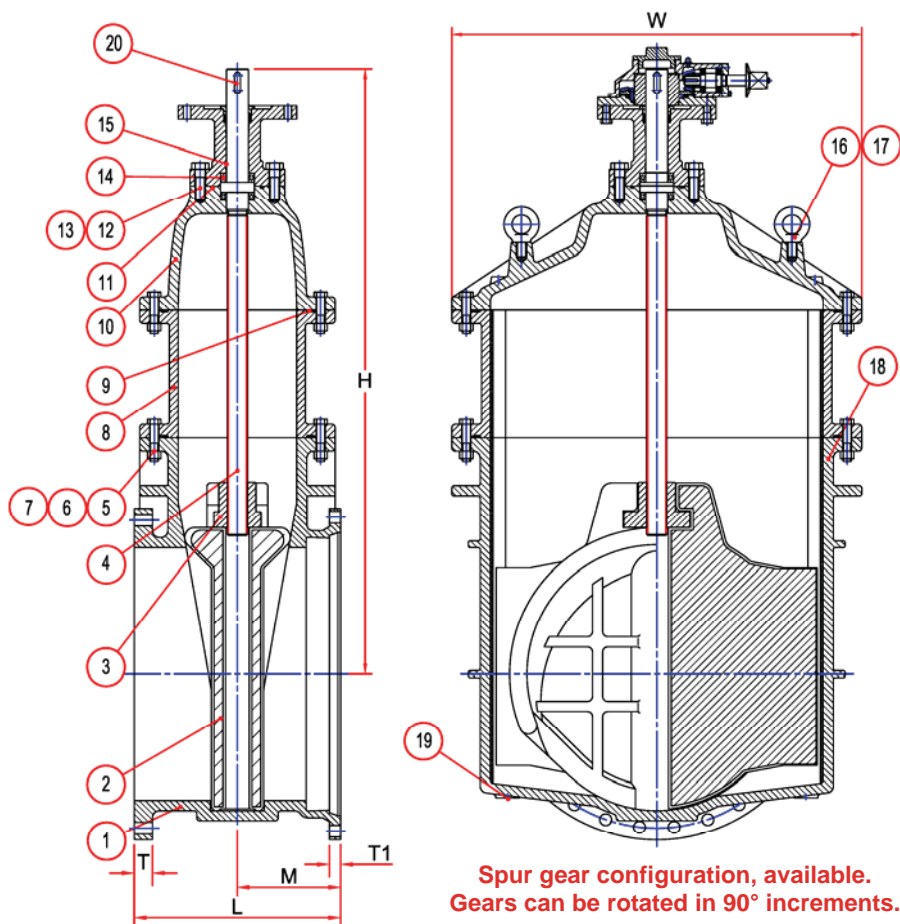

Spur gear configuration, available.  
Gears can be rotated in 90° increments.

No.	Part Name	Materials
1	Body	Ductile Iron ASTM A536 65-45-12
2	Wedge	Ductile Iron, EPDM Encapsulated
3	Stem Nut	Aluminum Bronze
4	Stem	Stainless Steel, Bronze Available
5	Bolt	Stainless Steel *
6	Nut	Stainless Steel *
7	Washer	Stainless Steel *
8	Bonnet Adapter	Ductile Iron ASTM A536 65-45-12
9	O-Ring Gasket	EPDM
10	Bonnet	Ductile Iron ASTM A536 65-45-12
11	O-Ring	EPDM
12	Bolt	Stainless Steel *
13	Nut	Stainless Steel *
14	Thrust Bearing	Copper
15	O-Ring	EPDM
16	Eye Bolt	Carbon Steel Zinc Plated
17	Washer	Stainless Steel *
18	Track	Stainless Steel ANSI 316
19	Plug	Brass ASTM B16
20	Key	Carbon Steel AISI 1045

## Features:

- Design and Materials Exceed AWWA C509, C515 & C550.
- Flanges Conform to ANSI B16.1, Class 125.  
MJ Conforms to ANSI/AWWA .
- C509 Thick wall Ductile Iron, Body, Bonnet, Wedge, and Gland.
- Fusion Bonded Epoxy Coatings In and Out per AWWA C550.
- Stainless Steel Nuts, Bolts, and Washers.
- Stainless Steel Stem, Bronze Available.
- Ductile Iron, EPDM Encapsulated Wedge.
- EPDM Gaskets and O-Rings.
- Available with Bypass.
- 2" AWWA Ductile Iron Nut Operator.

\* 42" & 48" Zinc Plated Hardware Standard

## Dimensions:

Size	Model	L	M	H	W	T	T1	Approx. Weight
30"	6630	24"	12"	70"	47¾"	2⅝"	1¼"	5,444#
36"	6636	28"	14"	81"	54¼"	2⅝"	1½"	8,664#
42"	6642	36"	18"	86½"	66¾"	2⅝"	1½"	14,242#
48"	6648	43"	21½"	96"	75½"	2¾"	1½"	20,005#